

Aufsteckfräsdorne SK40

arbors SK40 for shell cutter
mandrin SK40 pour fraises à creuse

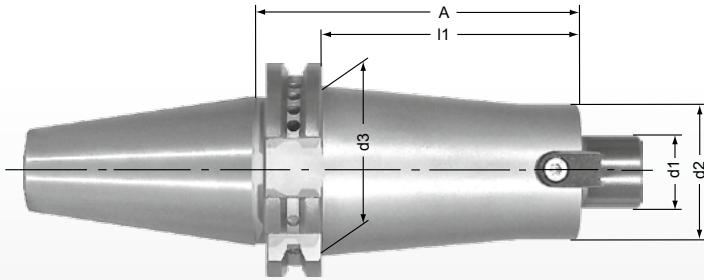

Lieferumfang: SK-Aufnahme mit Anzugsschraube und Mitnehmersteinen

delivery: with drive keys and retaining screw

entendue de livraison: avec vis de blocage des fraises et entraineur

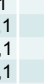

Bestell-Nr. order number No.	d1	d2	d3	l1	A					
972-SK401625	16	35	35	25	44,1	x	959-16	-	957-M8	-
972-SK401625ZY-30	16	30	30	25	44,1	x	959-16	-	957-M8	-
972-SK401650	16	35	42	50	69,1	x	959-16	-	957-M8	-
972-SK401650ZY-30	16	30	30	50	69,1	x	959-16	-	957-M8	-
972-SK401675	16	35	45	75	94,1	x	959-16	-	957-M8	-
972-SK4016100	16	35	50	100	119,1	x	959-16	-	957-M8	-
972-SK4016150	16	35	50	150	169,1	x	959-16	-	957-M8	-
972-SK4016200	16	35	50	200	219,1	x	959-16	-	957-M8	-
972-SK402225	22	40	40	25	44,1	x	959-22	-	957-M10	-
972-SK402250	22	40	45	50	69,1	x	959-22	-	957-M10	-
972-SK402275	22	40	50	75	94,1	x	959-22	-	957-M10	-
972-SK4022100	22	40	50	100	119,1	x	959-22	-	957-M10	-
972-SK4022125	22	40	50	125	144,1	x	959-22	-	957-M10	-
972-SK4022150	22	40	50	150	169,1	x	959-22	-	957-M10	-
972-SK4022200	22	40	50	200	219,1	x	959-22	-	957-M10	-
972-SK402725	27	45	45	25	44,1	x	959-27	-	957-M12	-
972-SK402750	27	45	45	50	69,1	x	959-27	-	957-M12	-
972-SK402775	27	45	45	75	94,1	x	959-27	-	957-M12	-
972-SK4027100	27	45	45	100	119,1	x	959-27	-	957-M12	-
972-SK4027150	27	48	50	150	169,1	x	959-27	-	957-M12	-

G6,3/8.000

Aufsteckfräsdorne SK50

arbors SK50 for shell cutter
mandrin SK50 pour fraises à creuse

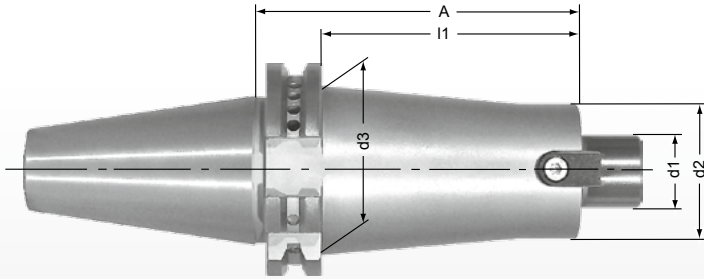

Lieferumfang: SK-Aufnahme mit Anzugsschraube und Mitnehmersteinen

delivery: with drive keys and retaining screw

entendue de livraison: avec vis de blocage des fraises et entraineur



Bestell-Nr. order number No.	d1	d2	d3	l1	A					
972-SK501650	16	35	40	50	69,1	x	959-16	-	957-M8	-
972-SK5016100	16	35	50	100	119,1	x	959-16	-	957-M8	-
972-SK5016150	16	35	53	150	169,1	x	959-16	-	957-M8	-
972-SK5016200	16	35	60	200	219,1	x	959-16	-	957-M8	-
972-SK502250	22	40	40	50	69,1	x	959-22	-	957-M10	-
972-SK5022100	22	40	50	100	119,1	x	959-22	-	957-M10	-
972-SK5022100ZY	22	48	48	100	119,1	x	959-22	-	957-M10	-
972-SK5022150	22	40	62	150	169,1	x	959-22	-	957-M10	-
972-SK5022150ZY	22	48	48	150	169,1	x	959-22	-	957-M10	-
972-SK5022200	22	40	68	200	219,1	x	959-22	-	957-M10	-
972-SK5022200ZY	22	48	48	200	219,1	x	959-22	-	957-M10	-
972-SK5022250	22	48	68	250	269,1	-	959-22	-	957-M10	-
972-SK5022250ZY	22	48	48	250	269,1	-	959-22	-	957-M10	-
972-SK5022300	22	48	68	300	319,1	-	959-22	-	957-M10	-
972-SK5022300ZY	22	48	48	300	319,1	-	959-22	-	957-M10	-
972-SK5022350	22	48	68	350	369,1	-	959-22	-	957-M10	-
972-SK502720	27	60	60	20	39,1	x	959-27	-	957-M12	-
972-SK502750	27	60	60	50	69,1	x	959-27	-	957-M12	-
972-SK5027100	27	60	70	100	119,1	x	959-27	-	957-M12	-
972-SK5027100ZY	27	60	60	100	119,1	x	959-27	-	957-M12	-
972-SK5027150	27	60	78	150	169,1	x	959-27	-	957-M12	-
972-SK5027150ZY	27	60	60	150	169,1	x	959-27	-	957-M12	-
972-SK5027200	27	60	78	200	219,1	x	959-27	-	957-M12	-
972-SK5027200ZY	27	60	60	200	219,1	x	959-27	-	957-M12	-
972-SK5027250	27	60	78	250	269,1	-	959-27	-	957-M12	-
972-SK5027250ZY	27	60	60	250	269,1	-	959-27	-	957-M12	-
972-SK5027300	27	60	78	300	319,1	-	959-27	-	957-M12	-
972-SK5027300ZY	27	60	60	300	319,1	-	959-27	-	957-M12	-
972-SK503250	32	70	70	50	69,1	-	959-32	957-32	-	958-32
972-SK5032100	32	70	95	100	119,1	-	959-32	957-32	-	958-32
972-SK5032150	32	70	95	150	169,1	-	959-32	957-32	-	958-32
972-SK504050	40	95	95	50	69,1	-	959-40	957-40	-	958-40
972-SK5040100	40	95	95	100	119,1	-	959-40	957-40	-	958-40

G6,3/8.000

Aufsteckfräsdorne SK40, 50 mit vergrößertem Anlagedurchmesser

arbors type SK40, 50 with enlarged contact surface diameter
mandrin avec diamètre de collerette élargi type SK40, 50

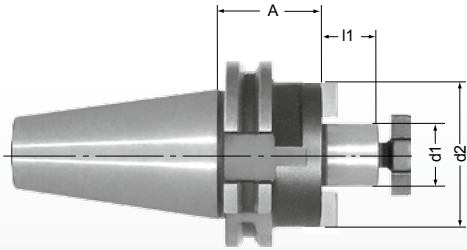



Lieferumfang: SK-Aufnahme mit Anzugsschraube und Mitnehmersteinen

delivery: with drive keys and retaining screw

entendue de livraison: avec vis de blocage des fraises et entraineur

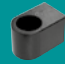

Bestell-Nr. order number No.	SK	d1	d2	l1	A				
968 - SK4016	SK40	16	40	17	35	-	959-16	957-16	958-16
968 - SK4022		22	50	19	35	-	959-22	957-22	958-22
968 - SK4027		27	50	21	35	-	959-27	957-27	958-27
968 - SK4032		32	78	24	50	-	959-32	957-32	958-32
968 - SK5022	SK50	22	50	19	35	-	959-22	957-22	958-22
968 - SK5027		27	60	21	35	-	959-27	957-27	958-27
968 - SK5032		32	78	24	35	-	959-32	957-32	958-32
968 - SK5040		40	89	27	50	-	959-40	957-40	958-40
968 - SK5050		50	120	30	70	-	959-50	957-50	958-50

G6,3/8.000



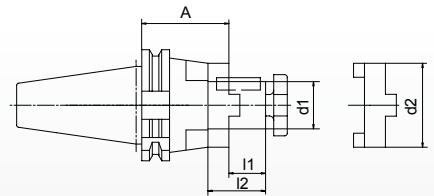
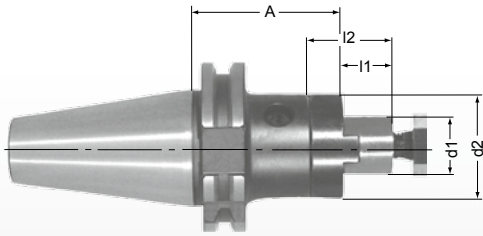

Kombi-Aufsteckfräsdorne SK40, 50

combi-arbors SK40, 50 with tenon and parallel key drive
 mandrin SK40, 50 combi pour fraises á entraînement par clavette ou tenon



Lieferumfang: SK-Aufnahme mit Anzugsschraube und Mitnehmersteinen
 delivery: with drive keys and retaining screw
 entendue de livraison: avec vis de blocage des fraises et entraîneur



Bestell-Nr. order number No.	SK	d1	d2	l1	l2	A					
966 - SK4016	SK40	16	32	17	27	55	955-16	956-16	957-16	958-16	G6,3/8.000
966 - SK4022		22	40	19	31	55	955-22	956-22	957-22	958-22	
966 - SK4027		27	48	21	33	55	955-27	956-27	957-27	958-27	
966 - SK4032		32	58	24	38	60	955-32	956-32	957-32	958-32	
966 - SK5016	SK50	16	32	17	27	55	955-16	956-16	957-16	958-16	
966 - SK5022		22	40	19	31	55	955-22	956-22	957-22	958-22	
966 - SK5027		27	48	21	33	55	955-27	956-27	957-27	958-27	
966 - SK5032		32	58	24	38	55	955-32	956-32	957-32	958-32	
966 - SK5040		40	70	27	41	55	955-40	956-40	957-40	958-40	